

Module replacement

- STEP 1 Deactivate the energy supplier
- STEP 2 Unplug all terminals from the modules, pressing the base and

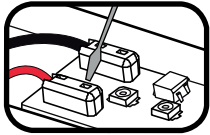

FIG. E

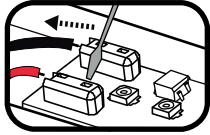
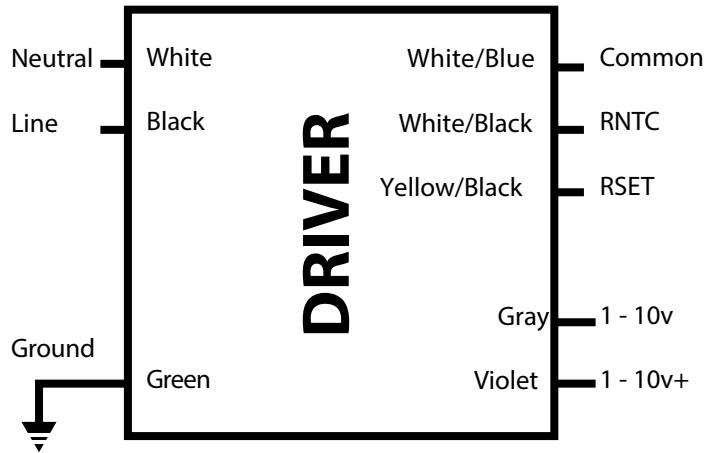

FIG. F

- STEP 3 Unscrew and take off the modules from the luminaire
- STEP 4 Place the new moduels and set them.  
 Note: The module has to be fully in contact with the luminaire for a better heat dissipation, if its not correctly set it can last less longer affecting the module lifespan.
- STEP 5 Plug the module terminals and reactivate the power supply.



This product was manufactured by:  
**Supra Desarrollos Tecnológicos, S.A. de C.V.**  
 RFC: SDT-880803-537  
 Antireeleccionistas #120-A Col. Antonio I. Villareal  
 C.P. 64390 Monterrey, N.L. México  
 Tel/Fax: 867-601-27 / 867-601-47  
 867-644-37/ 840-006-84  
 www.supradesarrollos.com  
 contacto@supradesarrollos.com

# SUPRALUX

## Installation Manual

**Mall**  
 120/277V~  
 50-60Hz

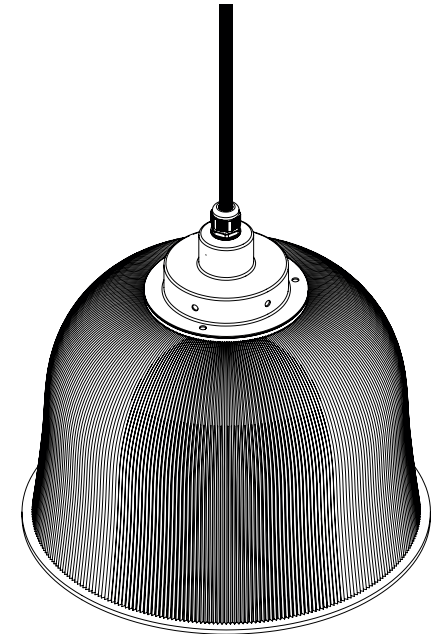

**IMPORTANT:**

Read the instructions prior to the installation

**Your safety and the safety of others its very important.**

Weve included important security messages in this manual.

 This is the symbol of security warning. Read and obey all the messages of security warning. This symbol calls for potencial danger that can cause an injury or even death to you and or others.

.All security messages will go next to a symbol of security warning and the word "DANGER" or "WARNING"

**Included parts**

- 1 luminaire with:
- Installation manual
  - Electronic ballast
  - Bases for lamps

**Tools you will need**

- Electric pliers
- Strippingwire pliers
- Electrical insulator
- Philips Tip Screwdriver
- Flat-blade screwdriver

**Before you start**

- Luminaire location:
- Identify the place where the luminaire is going to be installed.
  - Make sure you have everything you need to make a proper installation.

**Electrical Requirements**

Verify with a specialized electric technician that your power supply is the right one You must be aware that this electric installationrequires the next ccharacteristics:

- Nominal voltage: 120/277V
- Frecuency: 60Hz
- Power: 44 watts
- Nominal current: 0.38 - 0.16A

Country of origin: México

Elaborado por: Samantha Nieto Alvarez  
Revisión:01  
Vigencia apartir de 20/10/14

**Luminaire installation**

- STEP 1 Remove the luminaire from its package.
- STEP 2 Proceed and conect the electric wires.
- STEP 3 Embed the driver top
- STEP 4 Screw the ballast cover to the driver top

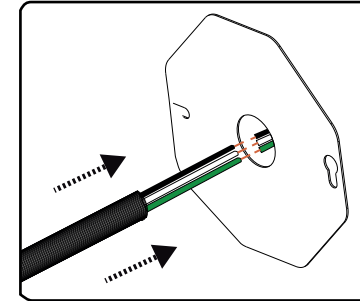

FIG. A

**Driver change**

- STEP 1 Deactivate the power supply
- STEP 2 Unscrew the driver top and remove the driver from the luminaire
- STEP 3 Proceed to conect the new driver and screw the ballast cover again.

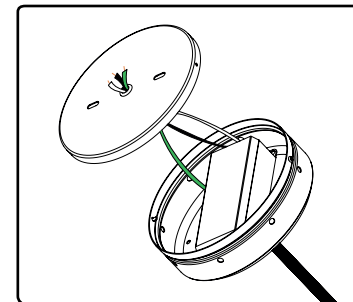

FIG. C

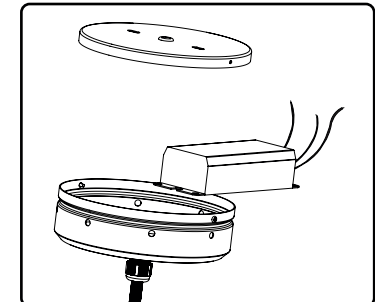

FIG. D